

DeWalt Cordless Impact Driver

Model DCF887

Safety & Use Instructions

- Only use 20v DeWalt battery packs supplied by the Pitsco Idea Shop.
- Remove battery after use and place on recharging station.
- Seek assistance from Pitsco Idea Shop staff with any questions.
- Use hex bits specifically designed for impact use.
- Do not wear loose clothing, jewelry or long hair when using this tool.
- Wear safety glasses or ANSI Z87.1 compliant safety goggles.
- Keep a firm grip on the tool at all times.
- Do not operate this tool for long periods of time.

[User Manual \(pdf\)](#)

RPM Ranges:

| DCF887 | | | |
|--------|----------------------|-----|--------|
| Mode 1 | Precision Drive | rpm | 0–1000 |
| Mode 2 | Normal Impacting | rpm | 0–2800 |
| Mode 3 | High Speed Impacting | rpm | 0–3250 |

Torque Ranges:

| Mode | Ft.-Lbs. | In.-Lbs. | Nm |
|------|----------|----------|-----|
| 1 | 20 | 240 | 27 |
| 2 | 125 | 1500 | 170 |
| 3 | 152 | 1825 | 205 |

Fig. A

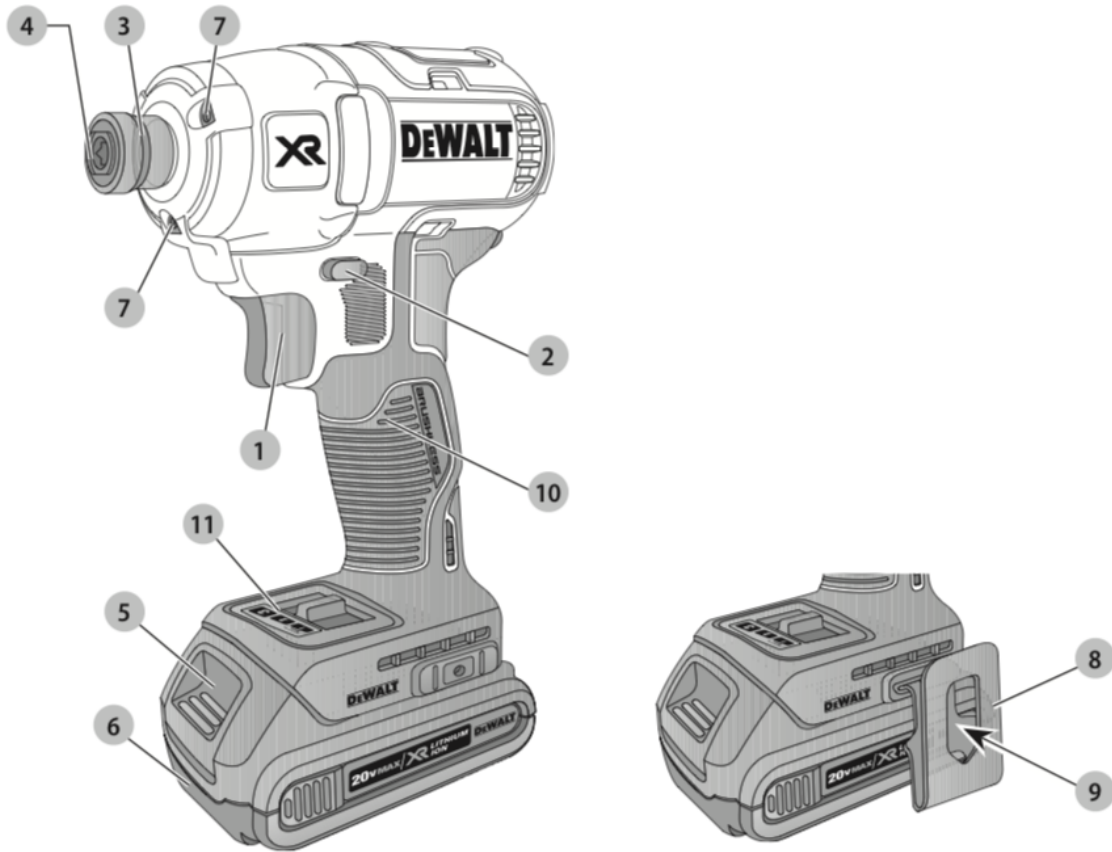

- 1 Trigger switch
- 2 Forward/reverse button
- 3 Chuck collar
- 4 1/4" (6.35 mm) hex quick-release chuck
- 5 Battery release button
- 6 Battery pack
- 7 Worklight
- 8 Belt hook (optional accessory)
- 9 Mounting screw
- 10 Main handle
- 11 Mode selector

⚠ WARNING! Read all safety warnings and all instructions. Failure to follow the warnings and instructions may result in electric shock, fire and/or serious injury.

👤 WARNING: To reduce the risk of injury, read the instruction manual.

If you have any questions or comments about this or any DEWALT tool, call us toll free at: 1-800-4-DEWALT (1-800-433-9258).