

Dremel Rotary Tool

Model 4000

Safety & Use Instructions

- Do not wear loose clothing, jewelry or long hair when using this tool.
- Use clamps or other practical way to secure and support the workpiece to a stable platform.
- Wear safety glasses or ANSI Z87.1 compliant safety goggles.
- Wear a dust mask during operation if warranted.
- Keep a firm grip on the tool at all times.
- Do not use accessories which are not specifically designed and recommended by the tool manufacturer.
- The outside diameter and the thickness of your accessory must be within the capacity rating of your power tool.
- The RATED SPEED of the accessories must be at least equal to the operating speed setting marked on the power tool.
- Always use the collet which matches the shank size of the accessory you plan to use. Seek assistance from Pitsco Idea Shop staff for assistance with collets and accessories.
- Clean up the work area and floor when finished to remove all accumulated debris.

Specific Rotary Tool Safety

- For detailed information about accessories for the Dremel Rotary Tool refer to the User Manual and seek assistance from the Pitsco Idea Shop staff as needed.
- The arbor size of wheels, sanding drums or any other accessory must properly fit the spindle or collet of the power tool.
- Mandrel mounted wheels, sanding drums, cutters or other accessories must be fully inserted into the collet or chuck.
- Do not use a damaged accessory. Before each use inspect the accessory such as abrasive wheels for chips and cracks, sanding drum for cracks, tear or excess wear, wire brush for loose or cracked wires.
- After inspecting and installing an accessory, position yourself and bystanders away from the plane of the rotating accessory and run the power tool at maximum no-load speed for one minute. Seek assistance from Pitsco Idea Shop staff if needed.
- Position the cord clear of the spinning accessory.
- Never lay the power tool down until the accessory has come to a complete stop.
- After changing the bits or making any adjustments, make sure the collet nut, chuck or any other adjustment devices are securely tightened.
- Keep bystanders a safe distance away from work area. Anyone entering the work area must wear personal protective equipment.
- Do not operate the power tool near flammable materials.

- Hold the power tool by insulated gripping surfaces only, when performing an operation where the cutting accessory may contact hidden wiring or its own cord.
- Allow for sufficient space, at least 6", between your hand and the spinning bit. Do not reach in the area of the spinning bit.
- Do not run the power tool while carrying it at your side.
- Regularly clean the power tool's air vents.
- Do not "jam" a cut-off wheel or apply excessive pressure.
- Do not attempt to make an excessive depth of cut.
- Use special care when working corners, sharp edges etc. Avoid bouncing and snagging the accessory.
- Do not position your hand in line with and behind the rotating wheel.
- Do not attach a toothed saw blade.
- Always feed the bit into the material in the same direction as the cutting edge is exiting from the material (which is the same direction as the chips are thrown).
- When using rotary files, cut-off wheels, high-speed cutters or tungsten carbide cutters, always have the work securely clamped.
- When wheel is pinched, snagged or when interrupting a cut for any reason, switch off the power tool and hold the power tool motionless until the wheel comes to a complete stop. Never attempt to remove the cut-off wheel from the cut while the wheel is in motion otherwise kickback may occur.
- For threaded abrasive cones and plugs use only undamaged wheel mandrels with an unrelieved shoulder flange that are of correct size and length.
- Do not restart the cutting operation in the workpiece. Let the wheel reach full speed and carefully re-enter the cut.
- Support panels or any oversized workpiece to minimize the risk of wheel pinching and kickback.
- Use extra caution when making a "pocket cut" into existing walls or other blind areas.

When using wire brush accessories:

- Be aware that wire bristles are thrown by the brush even during ordinary operation.
- Do not overstress the wires by applying excessive load to the brush.
- Allow brushes to run at operating speed for at least one minute before using them. During this time no one is to stand in front or in line with the brush.
- Direct the discharge of the spinning wire brush away from you.

[User Manual \(pdf\)](#)

Setting Tool Speed

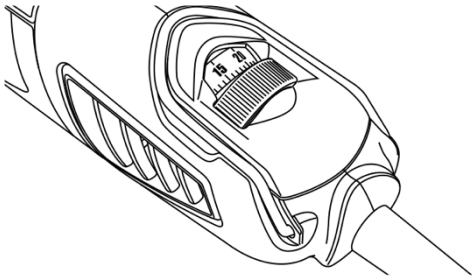

Consult the User Manual for information about tool speeds for various operations and materials. Seek assistance from Pitsco Idea Shop staff if needed.

Settings for Approximate Revolutions.

Switch Setting	Speed Range
5	5,000-7,000 RPM
*10	7,000-10,000 RPM
15	13,000-17,000 RPM
20	18,000-23,000 RPM
25	23,000-27,000 RPM
30	28,000-32,000 RPM
35	33,000-35,000 RPM

* Wire Brush Setting.

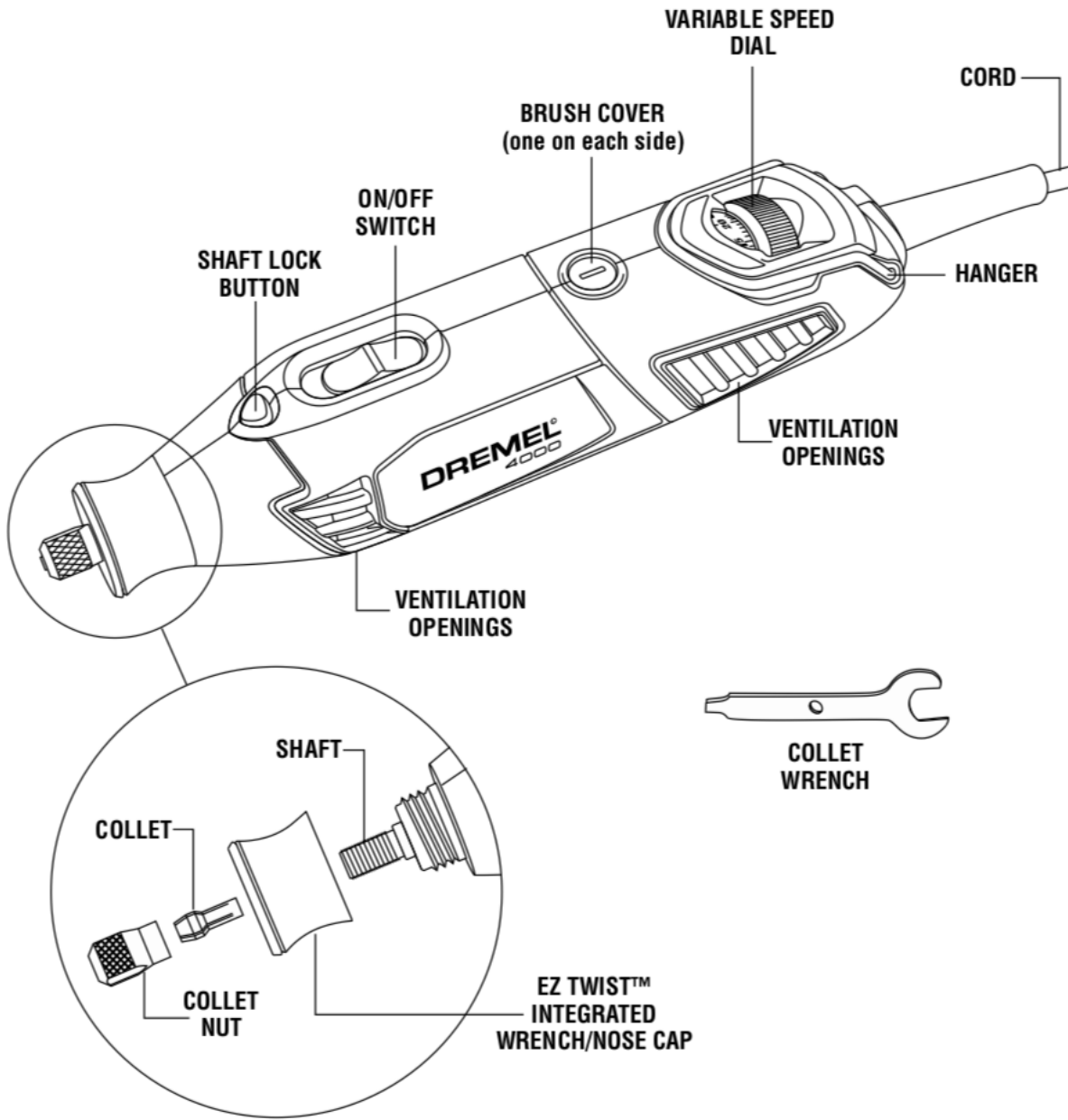

Model number	4000
Voltage rating	120V ~ 60Hz
Amperage rating	1.6A
Rated speed	n 5,000/35,000/min
Collet capacities	1/32, 1/16", 3/32", 1/8"